

INSTRUCTIONS

Thanks for purchasing this add-on. To apply the shadows please follow the instructions below -

1. Open the file named - '**Shadow Actions.EPS**'. Open the 'ACTIONS TAB'. This can be found in the 'WINDOWS' menu. In the right-hand corner drop-down menu, select 'LOAD ACTIONS'. Locate the file named 'shadow **Actions.AIA**' and click 'OPEN'. The Actions will now appear in the tab.
2. Select the text or vector shape that you want to apply the shadow to using the 'SELECTION TOOL'.

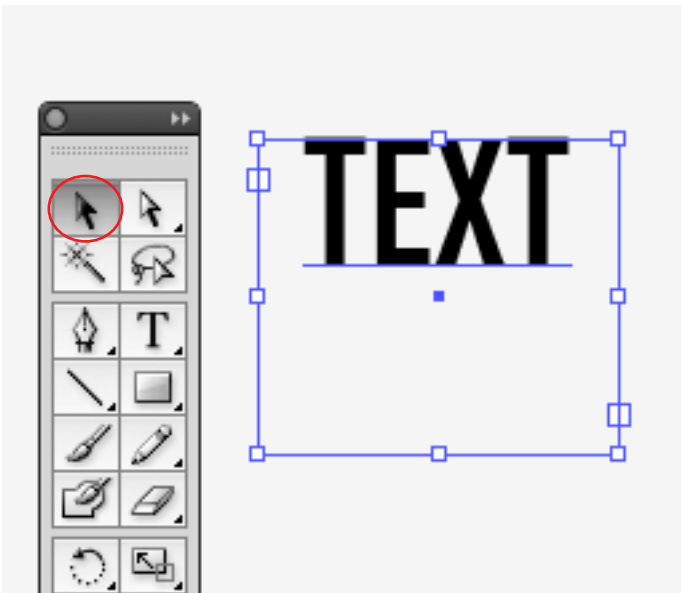
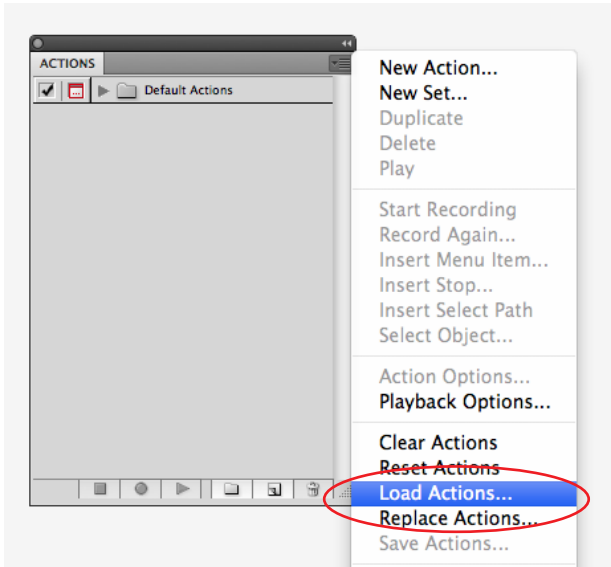

3. Choose an action from the 'ACTIONS TAB' and click on it. Then press the play button at the bottom of the same tab and your shadow will be applied!

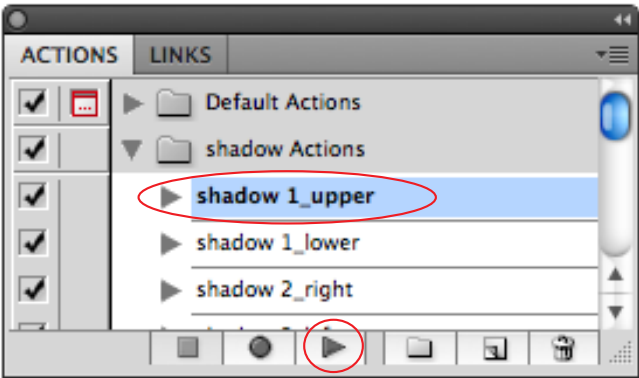

NOTES ON SHADOWS

The finished item contains two objects: your original text/object. And underneath it, the shadow. I'd suggest grouping the two layers once the item is complete. If you decide to edit the text/object after running the shadow action, the shadow WILL NOT automatically change with it. You will need to delete the shadow object and re-run the action.

EDITING THE SHADOWS

If you want to edit the shadow then open the 'APPEARANCE TAB' (this can be found in the 'WINDOWS' menu). Click the arrow on the 'FILL' layer and the shadow attributes will be revealed.

CHANGING OPACITY OF THE SHADOW

To change the transparency of the shadow click where it says ‘OPACITY’. A menu will open. Move the slider to the left to make the shadow lighter or to the right to darken it.

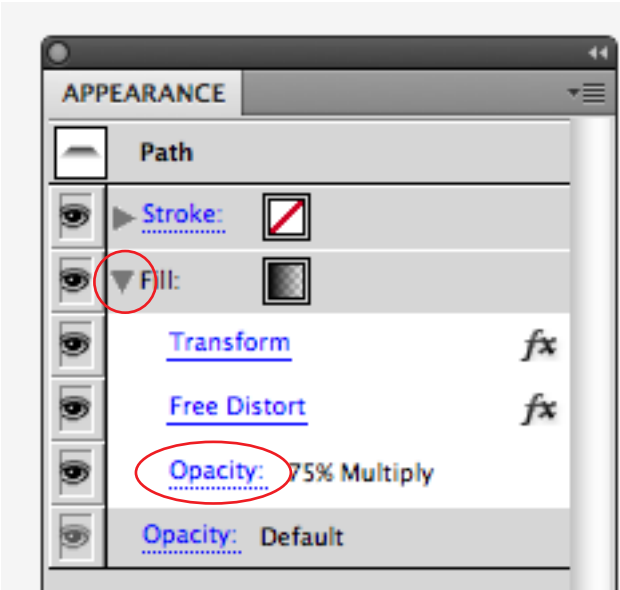
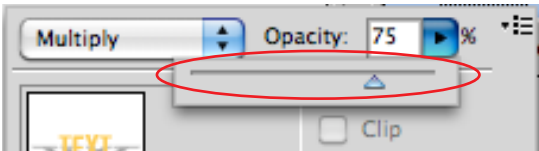

CHANGING THE COLOUR OF THE SHADOW

1. Click on the part of the 'APPEARANCE TAB' where you see the word 'FILL'
2. Open the 'GRADIENT' and 'COLOR' tabs (found in the 'WINDOWS' menu.
3. Click on one of the two square slider icons on the 'GRADIENT TAB'.
4. On the 'COLOR TAB' amend the color.
5. Repeat the process clicking on the second of the square slider icons.

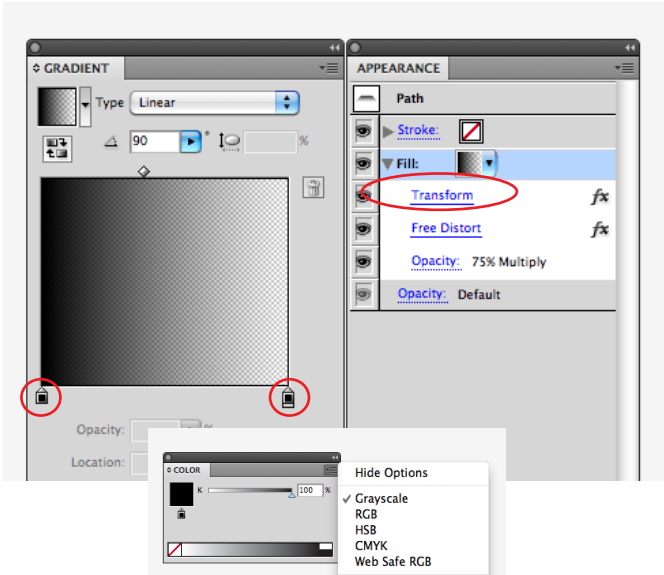

FOR TEXT/OBJECTS WITH STROKES

The actions are designed to work only on ‘fill’ objects or text. If you want to shadow those with strokes then expand the stroke to a fill and merge the object before applying the action.

If you like this please rate it!

For any assistance contact me @ childjeremy@hotmail.com